

Product Description

Type UB1 is a stainless steel universal load cell which allows for tension and compression loading. Its complete hermetic sealing makes it suitable for use in harsh industrial environments.

Application

- Crane scales and hanging scales, force measurement in material testing machines, cranes, lifts and other general tension applications

Key Features

- Capacities from 10 kN to 100 kN (1 020 kg to 10 197 kg)
- Stainless steel construction
- Environmental Protection IP68 with complete hermetic sealing
- Bi-direction (tension and compression)
- High input resistance
- Calibration in mV/V/Ω

Approvals

- OIML approval to C3 (Y = 5 700)
- NTEP approval to 5 000 intervals, Class III and 10 000 intervals, Class III L
- ATEX hazardous area approval for Zone 0, 1, 2, 20, 21 and 22
- FM hazardous area approval

Option

- Stainless steel cable gland

Packed Weight

■ Capacity (kN)	10	20	50	100
Weight (kg)	1.8	1.8	5.9	8.4

Available Accessories

- Compatible range of application hardware
- Compatible range of electronics

Specifications

	(E _{max})	kN	10 / 20 / 50 / 100	10 / 20 / 50	100
Maximum capacity	(E _{max})	kN	10 / 20 / 50 / 100	10 / 20 / 50	100
Metric equivalents (1 N=0.10197 kg)		kg	1 020 / 2 039 / 5 099 / 10 197	1 020 / 2 039 / 5 099	10 197
Minimum capacity	(E _{min})	%*E _{max}		0	
Accuracy class according to OIML R60			(GP)	C1	C3
Maximum number of verification intervals	(n _{max})		n.a.	1 000	3 000
Minimum load cell verification interval	(v _{min})		n.a.	E _{max} / 5 700	E _{max} / 5 700
Temperature effect on minimum dead load output	(TC ₀)	%*RO/10°C	± 0.0400	± 0.0280	± 0.0246
Temperature effect on sensitivity	(TC _{RO})	%*RO/10°C	± 0.0200	± 0.0160	± 0.0100
Combined error		%*RO	± 0.0500	± 0.0300	± 0.0200
Non-linearity		%*RO	± 0.0400	± 0.0300	± 0.0166
Hysteresis		%*RO	± 0.0400	± 0.0300	± 0.0166
Creep error (30 minutes) / DR		%*RO	± 0.0600	± 0.0490	± 0.0166
Rated Output	(RO)	mV/V		2 ± 0.1%	
Calibration in mV/V/Ω (A...I classified)		%		± 0.05 (± 0.005)	
Zero balance		%*RO		± 5	
Excitation voltage		V		5...15	
Input resistance	(R _{LC})	Ω		1 100 ± 50	
Output resistance	(R _{out})	Ω		1 000 ± 2	
Insulation resistance (100 V DC)		MΩ		≥ 5 000	
Safe load limit	(E _{lim})	%*E _{max}		200	
Ultimate load		%*E _{max}		300	
Compensated temperature range		°C		-10...+40	
Operating temperature range		°C		-40...+80 (ATEX -40...+60)	
Load cell material				stainless steel 17-4 PH (1.4548)	
Sealing				complete hermetic sealing; cable entry sealed by glass to metal header	
Protection according EN 60 529				IP68 (up to 2 m water depth) / IP69K	

* corresponds to C3 quality, currently no OIML R60 Test Certificate available
 The limits for Non-Linearity, Hysteresis, and TC_{RO} are typical values.
 The sum of Non-linearity, Hysteresis and TC_{RO} meets the requirements according to OIML R60 with p_{LC}=0.7.

Dimensions (in mm)

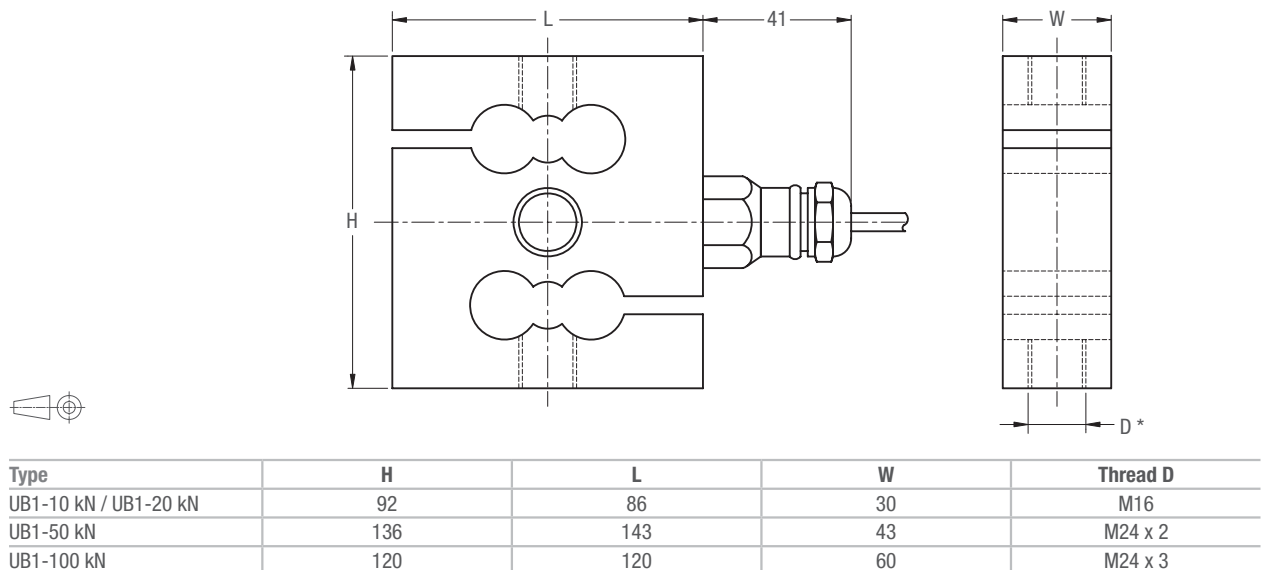

* Unified thread 5/8-18 UNF (10...20 kN) and 1-12 UNF (50 kN) is available.

Wiring

- The load cell is provided with a shielded, 4 conductor cable (AWG 24).
Cable jacket polyurethane
- Cable length: 6 m
- Cable diameter: 5 mm
- The shield is floating
(On request the shield can be connected to the load cell body)

