

# PS Drum Scale

Weigh and fill your drums anywhere



The PS Scale is specially designed for drum weighing and filling. With its portable structure, you can weigh and fill your drums directly next to the production tanks and reactors, in your warehouse or anywhere in your plant.

Thanks to the special size and low height platform and short ramp of the PS scale, full drums transported by the drum trolley can be easily loaded onto the PS scale. Similarly, filled drums can be easily loaded back into the drum trolley.

PS scale has a strong and durable structure that allows safe loading and unloading of full drums, galvanized and stainless steel models are available.

It has different weighing indicator options suitable for industrial field conditions, stainless steel, battery powered and ATEX Zone-II approved. When necessary, the weighing records can be transferred to the printer and computer via wired or wireless.

## Mobile Robust Construction

- 35mm height allows easy loading - unloading drums
- Shock loading resistant
- Galvanised or optional stainless steel platform
- Industrial stainless steel, IP67 protected, battery powered indicators



## Easy Practical Operation





- Weighing and filling drums at any location
- Operator prompting by colour changing display
- ATEX Zone-2 version
- Wireless data transfer to Printer, PC or Server.



# Technical Specifications

Approval	OIML Class III
Capacity	300 Kg
Readability	100g ( Approved ) / 50g ( Industrial )
Construction	Galvanised standard / Stainless steel optional
Load cells	Alloy steel standard / Stainless steel optional
Indicator	Different model; all stainless steel, EU OIML approved
Power	Rechargeable battery

## Indicators

Model	Image	Specifications
BX21S		<ul style="list-style-type: none"> <li>Stainless steel, IP66 protected.</li> <li>Printout as Date, Time, CN, Gross, Tare and Net.</li> <li>Li-Ion battery with internal Charger.</li> </ul>
BX24		<ul style="list-style-type: none"> <li>Stainless steel, IP67 protected.</li> <li>2 x user configurable ID.</li> <li>Printout as Date, Time, 2xIDs, CN, Gross, Tare and Net with barcode.</li> </ul>
BX25		<ul style="list-style-type: none"> <li>Stainless steel, IP67 protected.</li> <li>2 x user configurable ID.</li> <li>Printout as Date, Time, 2xIDs, CN, Gross, Tare and Net with barcode.</li> <li>Direct connection to Barcode Reader.</li> <li>Touchless usage by infrared switches.</li> </ul>
BX23Ex	 	<ul style="list-style-type: none"> <li>Stainless steel IP67 protected.</li> <li>ATEX Zone-2 approved.</li> <li>SS ATEX Zone-2 approved battery.</li> <li>RS232C, RS458, Ethernet TCP/IP standard.</li> </ul>

## Sizes (mm)

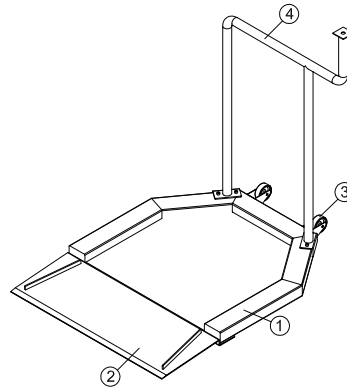
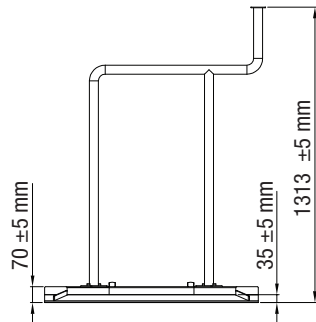
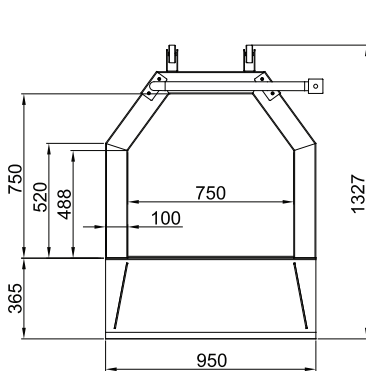

Item No	Item List
1	PS Platform Structure
2	Ramp
3	Wheel
4	Transport and Indicator Mounting Pole

## Options & Peripherals



Fully stainless steel construction

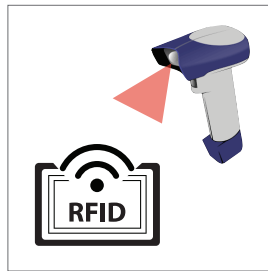

Barcode reader



Printer



Wireless output

(Specifications are subject to change without notice. 06 -01/ 2023)