

Ex-proof Junction Boxes BJ-Ex

Industrial junction boxes for hazardous areas



Typical Applications

- Platform scales which have multi load cells
- Ex-proof Weighbridges
- Industrial weighing systems
- Extension of the load cell cable in hazardous area



Features

- Up to 8 load cell connection
- Polyester, aluminium and stainless steel housings
- Atex certified products
- For zone 1 and zone 2



Suitable for Various Industries

- Designed for harsh industrial conditions
- From wet to hygienic environments
- Easy cleaning models
- Resistant to different chemicals
- Wide temperature range



Baykon BJ-Ex series ex-proof junction boxes are compliant with hazardous area regulations to provide sufficient protection against explosive risks at Zone 1 and Zone 2.

Baykon BJ-Ex series ex-proof junction boxes can be connected with shielded 6 wire cable to the weighing instrument to eliminate error coming from the instrument cable.

These junction boxes do not reduce the accuracy in every kind of industrial weighing applications including tank scales, hopper scales, conveyor scales, platform scales etc. The scales equipped with Baykon ex-proof junction boxes can be used in wet and hygienic environments.

BAYKON
Industrial Weighing Systems

Specifications

	BJA-03Ex	BJP-04Ex	BJA-04Ex	BJA-08Ex	BJS-04Ex
Hazardous protection	Eex d IIC T6/T5/T4	II 2G Ex e IIC T6 Gb II 2D Ex tb IIIC		II 2G Ex e IIC T6/T5/T4 Gb II 2G Ex ia IIC T6/T5/T4 Gb	
Load cell quantity	Up to 3		Up to 4	Up to 8	Up to 4
External grounding	Yes	No		Yes	
Sealing	No			Available	
Enclosure material	Aluminum	Polyester		Aluminum	Stainless steel
Protection class			IP66		
Cable glands	Galvanized steel R1/2		PG9 Polyamide		PG9 Nickel-plated brass
Cable diameter	4 to 10 mm.			4 to 8 mm.	
Humidity			90% RH max, non condensing		
Dimensions	87 x 55 x 230 mm.	75 x 56 x 160 mm.	64 x 35 x 150 mm.	80 x 52 x 250 mm.	100 x 65 x 200 mm.
Weight (packed)	1070 gr.	600 gr.	450 gr.	1230 gr.	1180 gr.

Dimensions

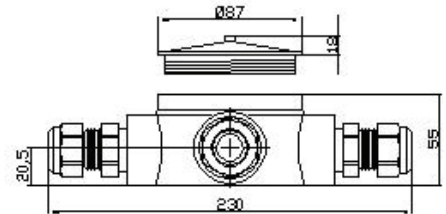
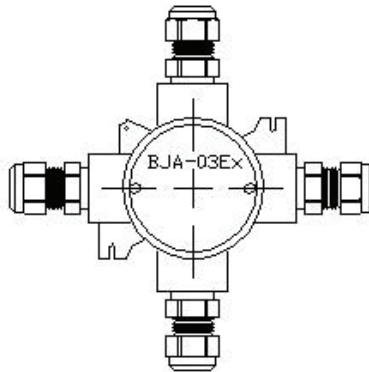
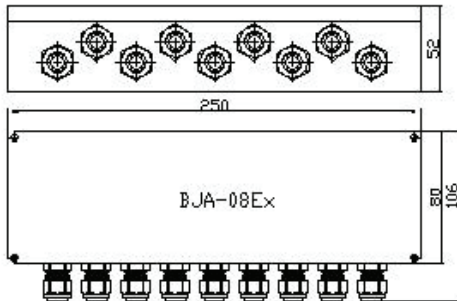
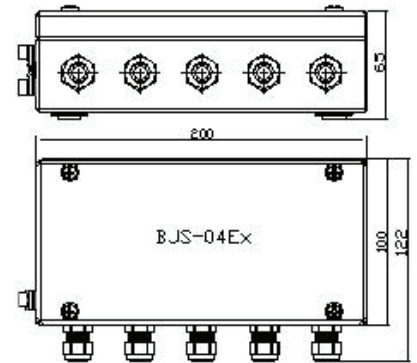
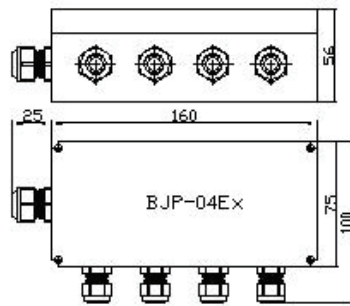
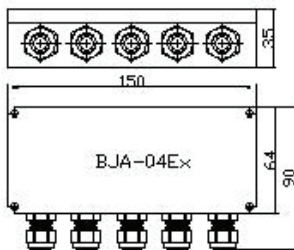

Order Configuration for Baykon J. Boxes

BJS - 04Ex

Baykon Junction Box

Enclosure

P: Industrial Plastic
A: Aluminium
S: Stainless Steel

Load Cell Connection

03: for 3 loads cells (only Ex.)
04: for 4 load cells
08: for 6 or 8 load cells

Description

G: General purpose, floor scales
A: Low profile scales
L: Lightning protection
Ex: Explosion Proof

(Specifications are subject to change without notice. 03 / 2016)

BAYKON
Industrial Weighing Systems

Kimya Sanayicileri O.S.B. Organik Cad. No: 31
Tepeören 34956 Tuzla / İstanbul / TURKEY
T. +90 216 593 26 30 • F. +90 216 593 26 38
info@baykon.com www.baykon.com