

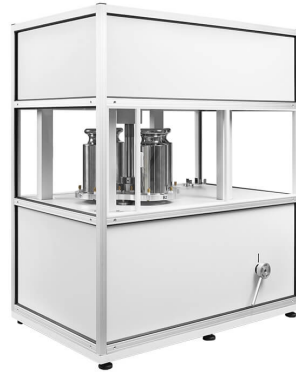

More information on the website
radwag.com/en/info,w1,A9NAV

AK-4.100.1.5Y Automatic Mass Comparators, AK-4.100.5Y Automatic Mass Comparators, AK-4.1000.5Y Automatic Mass Comparators, AK-4.10000.5Y Automatic Mass Comparators, AK-4.2000.5Y Automatic Mass Comparators, AK-4.1001.5Y Automatic Mass Comparators, AK-4.5000.5Y Automatic Mass Comparators



AK-4.100.1.5Y Automatic Mass Comparators
AK-4.100.5Y Automatic Mass Comparators
AK-4.1000.5Y Automatic Mass Comparators
AK-4.2000.5Y Automatic Mass Comparators
AK-4.1001.5Y Automatic Mass Comparators

AK-4.10000.5Y Automatic Mass Comparators

AK-4.5000.5Y Automatic Mass Comparators

The drawings, photos and graphics used are for illustrative purposes only.

Datasheet

| | AK-4.1000.5Y Automatic Mass Comparators | AK-4.1001.5Y Automatic Mass Comparators | AK-4.2000.5Y Automatic Mass Comparators |
|--|---|---|---|
| Metrological parameters | | | |
| E1 Calibration Range | 100 g ÷ 1 kg | 100 g ÷ 1 kg | 200 g ÷ 2 kg |
| E2 Calibration Range | 100 g ÷ 1 kg | 100 g ÷ 1 kg | 200 g ÷ 2 kg |
| F1 Calibration Range | 100 g ÷ 1 kg | 100 g ÷ 1 kg | 200 g ÷ 2 kg |
| F2 Calibration Range | 100 g ÷ 1 kg | 100 g ÷ 1 kg | 200 g ÷ 2 kg |
| Maximum capacity [Max] | 1,02 kg | 1,02 kg | 2,05 kg |
| Readability [d] | 0,005 mg | 0,001 mg | 0,01 mg |
| Standard repeatability [5% Max] | 8 µg | 1,7 µg | 12 µg |
| Standard repeatability [Max] | 15 µg | 2 µg | 15 µg |
| Permissible repeatability | 25 µg | 3,5 µg | 25 µg |
| Eccentricity (tested load) | — | — | — |
| Electric compensation range | -10 g ÷ +20 g | 1 g ÷ 10 g | -10 g ÷ +20 g |
| Stabilization time | 30 s | 30 s | 30 s |
| Adjustment | external | external | external |
| Physical parameters | | | |
| Display | 10" touchscreen | 10" touchscreen | 10" touchscreen |
| Magazine positions | 4 | 4 | 4 |
| Weighing pan dimensions | ø50 mm | ø50 mm | ø75 mm |
| Weighing device dimensions | 385×215×600 mm | 385×215×600 mm | 385×215×600 mm |
| Controlling device dimensions | 249×170×72 mm | 249×170×72 mm | 249×170×72 mm |
| Anti-draft chamber dimensions | 560×340×665 mm | 560×340×665 mm | 560×340×665 mm |
| Packaging dimensions | 860×800×560 mm | 760×860×560 mm | 860×800×560 mm |
| Chamber packaging size | 950×420×630 mm | 950×420×630 mm | 950×420×630 mm |
| Net weight | 47,8 kg | 26 kg | 69 kg |
| Gross weight | 67,8 kg | 42 kg | 96 kg |
| Communication interface | | | |
| Communication interface | USB-A ×2, USB-C, HDMI, Ethernet, Wi-Fi, Hotspot | USB-A ×2, USB-C, HDMI, Ethernet, Wi-Fi, Hotspot | USB-A ×2, USB-C, HDMI, Ethernet, Wi-Fi, Hotspot |
| Electrical parameters | | | |
| Power supply | 100 – 240 V AC 50/60 Hz | 100 – 240 V AC 50/60 Hz | 100 – 240 V AC 50/60 Hz |
| Environmental conditions | | | |
| Operating temperature | +15 ÷ +30 °C | +15 ÷ +30 °C | +15 ÷ +30 °C |
| Operating temperature change rate | ±0,5°C/12h (±0,3°C/4h) | ±0,5°C/12h (±0,3°C/4h) | ±0,5°C/12h (±0,3°C/4h) |
| Relative humidity change rate | ±5%/12h (3%/4h) | ±5%/12h (3%/4h) | ±5%/12h (3%/4h) |

Repeatability is expressed as a standard deviation determined for 6 ABBA cycles. Standard deviation is experimentally determined under ambient conditions for calibration of E1 class mass standards specified in OIML R111 (Table C.1.) document.

Datasheet

| | AK-4.5000.5Y Automatic Mass Comparators | AK-4.10000.5Y Automatic Mass Comparators | AK-4.100.5Y Automatic Mass Comparators |
|--|---|---|---|
| Metrological parameters | | | |
| E1 Calibration Range | 1 kg ÷ 5 kg | 500 g ÷ 10 kg | 10 g ÷ 100 g |
| E2 Calibration Range | 1 kg ÷ 5 kg | 500 g ÷ 10 kg | 10 g ÷ 100 g |
| F1 Calibration Range | 1 kg ÷ 5 kg | 500 g ÷ 10 kg | 10 g ÷ 100 g |
| F2 Calibration Range | 1 kg ÷ 5 kg | 500 g ÷ 10 kg | 10 g ÷ 100 g |
| Maximum capacity [Max] | 5,05 kg | 10,05 kg | 110 g |
| Readability [d] | 0,01 mg | 0,01 mg | 0,001 mg |
| Standard repeatability [5% Max] | 15 µg | 15 µg | 1,5 µg |
| Standard repeatability [Max] | 20 µg | 20 µg | 2 µg |
| Permissible repeatability | 35 µg | 40 µg | 3,5 µg |
| Eccentricity (tested load) | — | — | — |
| Electric compensation range | -10 g ÷ +50 g | -10 g ÷ +50 g | -1 g ÷ +10 g |
| Stabilization time | 30 s | 30 s | 30 s |
| Adjustment | external | external | external |
| Physical parameters | | | |
| Display | 10" touchscreen | 10" touchscreen | 10" touchscreen |
| Magazine positions | — | — | 4 |
| Weighing pan dimensions | ø75 mm | ø100 mm | ø24 mm |
| Weighing device dimensions | 350×405×650 mm | 800×500×930 mm | 385×215×600 mm |
| Controlling device dimensions | 249×170×72 mm | 249×170×72 mm | 249×170×72 mm |
| Anti-draft chamber dimensions | 660×470×700 mm | — | 560×340×665 mm |
| Packaging dimensions | 1000×900×685 mm | 1000×900×685 mm | 860×800×560 mm |
| Chamber packaging size | 930×750×1000 mm | 1100×800×1150 mm | 950×420×630 mm |
| Net weight | 71 kg | 91 kg | 46,8 kg |
| Gross weight | 98 kg | 141 kg | 66,8 kg |
| Communication interface | | | |
| Communication interface | USB-A ×2, USB-C, HDMI, Ethernet, Wi-Fi, Hotspot | USB-A ×2, USB-C, HDMI, Ethernet, Wi-Fi, Hotspot | USB-A ×2, USB-C, HDMI, Ethernet, Wi-Fi, Hotspot |
| Electrical parameters | | | |
| Power supply | 100 – 240 V AC 50/60 Hz | 100 – 240 V AC 50/60 Hz | 100 – 240 V AC 50/60 Hz |
| Environmental conditions | | | |
| Operating temperature | +15 ÷ +30 °C | +15 ÷ +30 °C | +15 ÷ +30 °C |
| Operating temperature change rate | ±0,5°C/12h (±0,3°C/4h) | ±0,5°C/12h (±0,3°C/4h) | ±0,5°C/12h (±0,3°C/4h) |
| Relative humidity change rate | ±5%/12h (3%/4h) | ±5%/12h (3%/4h) | ±5%/12h (3%/4h) |

Repeatability is expressed as a standard deviation determined for 6 ABBA cycles. Standard deviation is experimentally determined under ambient conditions for calibration of E1 class mass standards specified in OIML R111 (Table C.1.) document.

Datasheet

| AK-4.100.1.5Y Automatic Mass Comparators | |
|--|---|
| Metrological parameters | |
| E1 Calibration Range | 10 g ÷ 100 g |
| E2 Calibration Range | 10 g ÷ 100 g |
| F1 Calibration Range | 10 g ÷ 100 g |
| F2 Calibration Range | 10 g ÷ 100 g |
| Maximum capacity [Max] | 110 g |
| Readability [d] | 0,1 µg |
| Standard repeatability [5% Max] | 0,8 µg |
| Standard repeatability [Max] | 0,8 µg |
| Permissible repeatability | 1,5 µg |
| Eccentricity (tested load) | — |
| Electric compensation range | -1 g ÷ +6 g |
| Stabilization time | 30 s |
| Adjustment | external |
| Physical parameters | |
| Display | 10" touchscreen |
| Magazine positions | 4 |
| Weighing pan dimensions | ø24 mm |
| Weighing device dimensions | 385×215×600 mm |
| Controlling device dimensions | 249×170×72 mm |
| Anti-draft chamber dimensions | 560×340×665 mm |
| Packaging dimensions | 860×800×560 mm |
| Chamber packaging size | 950×420×630 mm |
| Net weight | 45,8 kg |
| Gross weight | 65,8 kg |
| Communication interface | |
| Communication interface | USB-A ×2, USB-C, HDMI, Ethernet, Wi-Fi, Hotspot |
| Electrical parameters | |
| Power supply | 100 – 240 V AC 50/60 Hz |
| Environmental conditions | |
| Operating temperature | +15 ÷ +30 °C |
| Operating temperature change rate | ±0,5°C/12h (±0,3°C/4h) |
| Relative humidity change rate | ±5%/12h (3%/4h) |

Repeatability is expressed as a standard deviation determined for 6 ABBA cycles. Standard deviation is experimentally determined under ambient conditions for calibration of E1 class mass standards specified in OIML R111 (Table C.1.) document.

* Wi-Fi® is a registered trademark of Wi-Fi® Alliance.

Accessories

RFID Tags
Antivibration Tables
Additional modules
Protective cover for balances
Barcode scanners
RS 232, RS 485 cables

THBR 2.0 System - Ambient Conditions Monitoring
Receipt Printer
Fingerprint Reader
RS 232, RS 485 cables
RS 232 cables (scale - printer)

Software

RAD-KEY
RMCS System

RMCS Lite

Device dimensions

AK-4.100.1.5Y Automatic Mass Comparators, AK-4.100.5Y Automatic Mass Comparators, AK-4.1000.5Y Automatic Mass Comparators, AK-4.10000.5Y Automatic Mass Comparators, AK-4.2000.5Y Automatic Mass Comparators, AK-4.1001.5Y Automatic Mass Comparators, AK-4.5000.5Y Automatic Mass Comparators

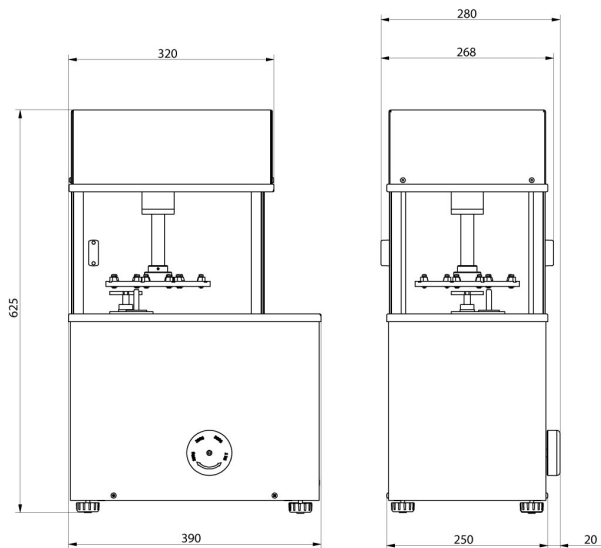

AK-4/100, AK-4/1000,
AK-4/1000.1

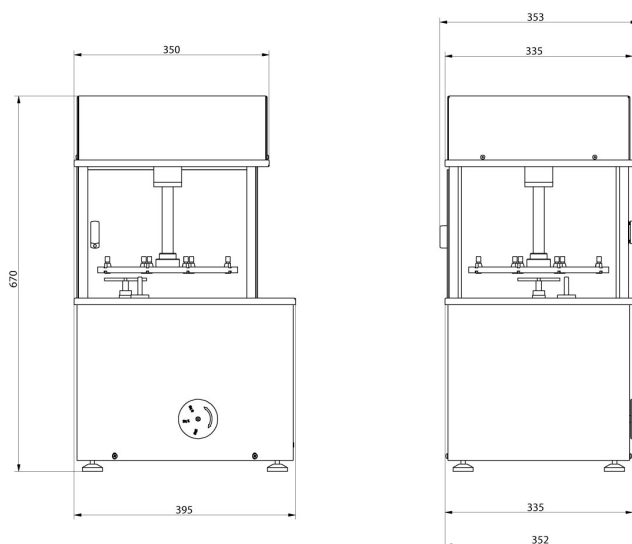

AK-4/2000, AK-4/5000,
AK-4/5000.1

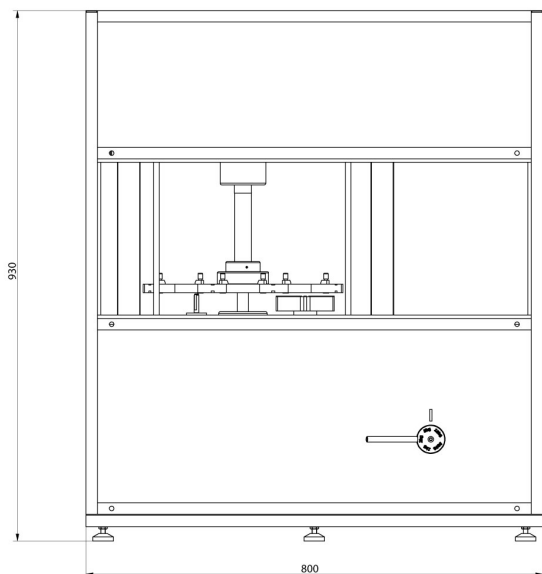

AK-4/10000, AK-4/16000

